

DESCRIPTION: All alu-cap	CUSTOMER DRAWING	PRODUCT NUMBER: CT013.0001 Product Number old: AM1306
--------------------------	------------------	--

scale 1:1

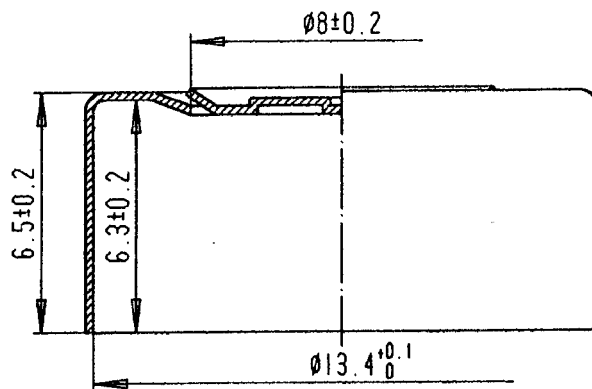
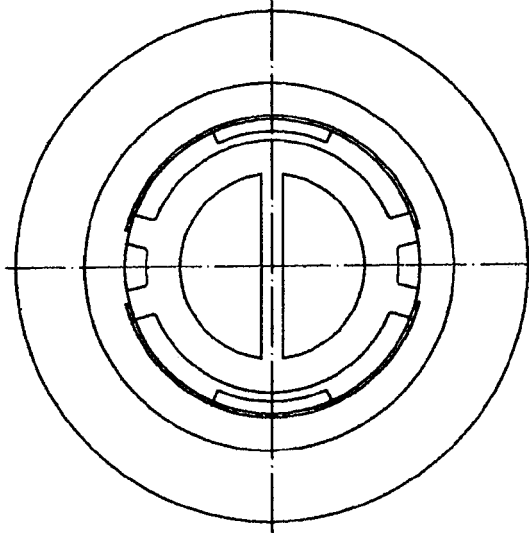
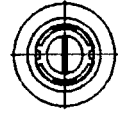

Printed copies will not be systematically updated

PARTS LIST	pos.	ref.no.	description	material	remarks	MODIFICATION	index	modification	date	name
							B	general revision	22.06.05	Gilpert
A	total revision	25.11.04	Gilpert							

DRAWING	TRACED: Gilpert DATE: 22.06.05 CHECKED DATE 4.07.05' SIGNATURE: <i>C. Weyen</i> SCALE: 5:1, 1:1			
	DERIVED FROM DRAWING AM1306	DATED 17.08.98	FILE-REF. (CAD-no.) A279K	PROJECTION:
	REPLACES PRODUCT DRAWING -----	DATED -----	MATERIAL: AL (0.20±0.02)	

VALIDITY	VALID DATE 29.06.05	AUTHORIZED by <i>[Signature]</i>	SIGNATURE <i>Annacklinger</i>
----------	---------------------	----------------------------------	-------------------------------

This drawing is the property of Helvoet Pharma and may be not be copied nor disclosed to third parties without our written consent.
Dimensions without tolerance indication correspond to ISO 2768 m. Cut or punched edges can be slightly conical, excentric and/or variable.