

DESCRIPTION: All-alu-cap

CUSTOMER DRAWING

PRODUCT NUMBER: CT020.0002  
Product Number old: AM2012

scale 1:1

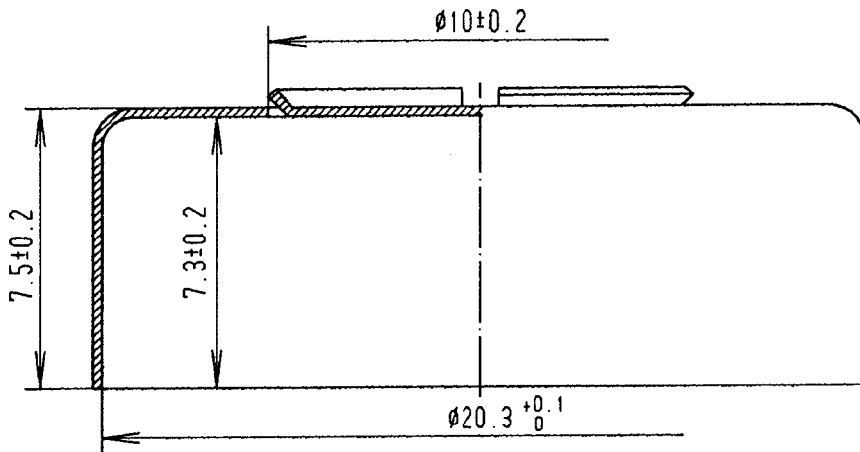
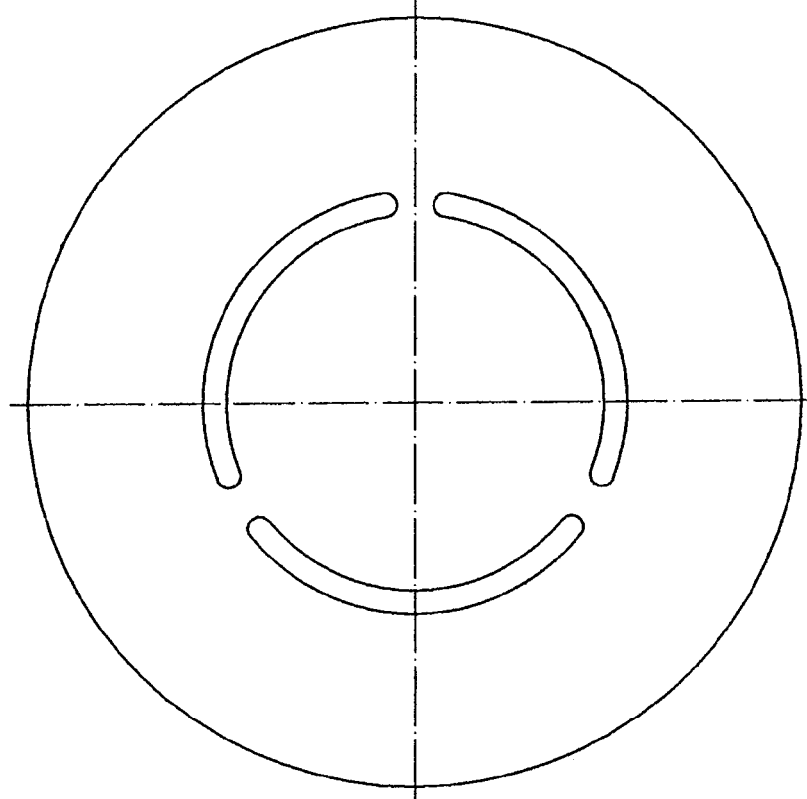

PARTS LIST	pos.	ref. no.	description	material	remarks	MODIFICATION			
							index	modification	date
						B	general revision	08.08.05	Amschl
						A	total revision	14.07.04	Gilpert

DRAWING	TRACED: Gilpert	DATE: 14.07.04	CHECKED DATE 10.08.05	SIGNATURE: <i>[Signature]</i>	SCALE: 5:1, 1:1
	DERIVED FROM DRAWING AM2012 (HPD)	DATED 24.06.99	FILE-REF. (CAD-no.) A607K	PROJECTION:	
	REPLACES PRODUCT DRAWING -----	DATED -----	MATERIAL: AL (0.20±0.02)		
VALIDITY	VALID DATE 10.08.05	AUTHORIZED by <i>[Signature]</i>	SIGNATURE <i>Amschlinges</i>		

This drawing is the property of Helvoet Pharma and may be not be copied nor disclosed to third parties without our written consent.  
Dimensions without tolerance indication correspond to ISO 2768 m. Cut or punched edges can be slightly conical, excentric and/or variable.

Printed copies will not be systematically updated